

PRELIMINARY PUD PLAN
BECK PROPERTY
 OXFORD TOWNSHIP
 BUTLER COUNTY, OHIO
 SECTION 14, TOWN 5, RANGE 1

OWNER/DEVELOPER
 Michael A. Beck, Co-Trustee, Etal.
 38 Coventry Wood Road
 Bolton, MA 01740

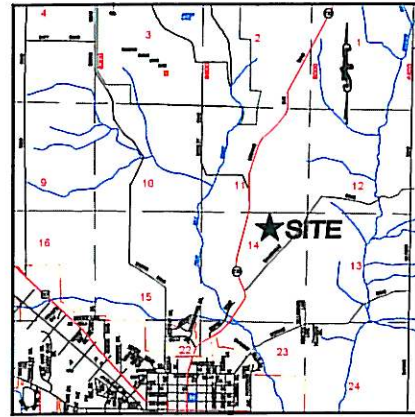

VICINITY MAP

PROJECT DATA

Total # Single Family Building Sites = 5
 Total Acreage = 85.48 Acres
 Total Open Space = 70.82 Acres (82.8%)
 Over-All Density = 0.058/Ac.

GENERAL NOTES

1. Water to be installed and connected to Southwest Regional Water District.
2. Sanitary to be provided via onsite treatment systems.
3. Electric to be supplied by Duke Energy.
4. Private drive to be maintained by future homeowners.
5. Contours furnished from aerial photography based on U.S.G.S. datum.
6. Exact locations of home sites are subject to future homeowners discretion but shall remain in the Residential Building Zones.
7. Total Acreage: 85.48 Acres
8. Existing Zoning: A-1 Agricultural Zone

RECEIVED
 FEB 17 2015
 BUTLER COUNTY
 PLANNING COMMISSION

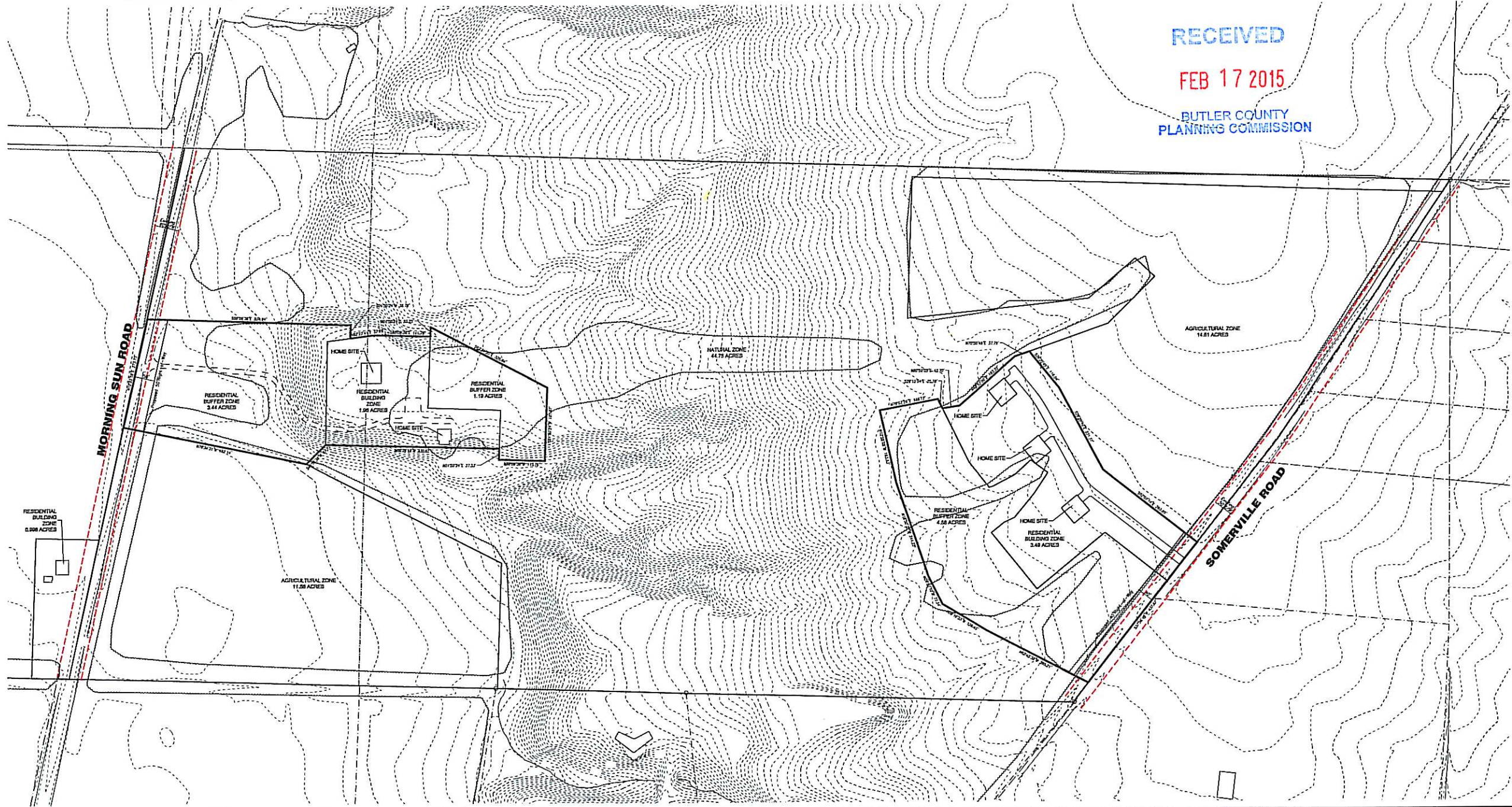

State of Ohio
 Butler County Planning Commission
 218 S. College Avenue
 Oxford, OH 45056 - 513.523.6725

No.	Date	Drawn	Checked	Reviewed	Revision Description

BECK PROPERTY
 SECTION 14, TOWN 5, RANGE 1
 OXFORD TOWNSHIP
 BUTLER COUNTY
 OHIO

PRELIMINARY PUD

boyer becker
 Engineering & Architecture
 218 S. College Avenue
 Oxford, OH 45056 - 513.523.6725

Drawing No.	140006-000 PRELIM2
Drawn by	TAC
Checked by	XXX
Issue Date	2-16-15
Scale	1/1

All dimensions shall be as shown on this drawing. No field verification shall be required. The engineer and architect accept no responsibility for the accuracy of the data furnished by the client. The engineer and architect accept no responsibility for the accuracy of the data furnished by the client.