

2 x 4 pressure treated bottom plate
 w/ hot dipped galvanized anchor
 bolts 1/2" x 10" 6' o.c. or approved
 straps 3' o.c.

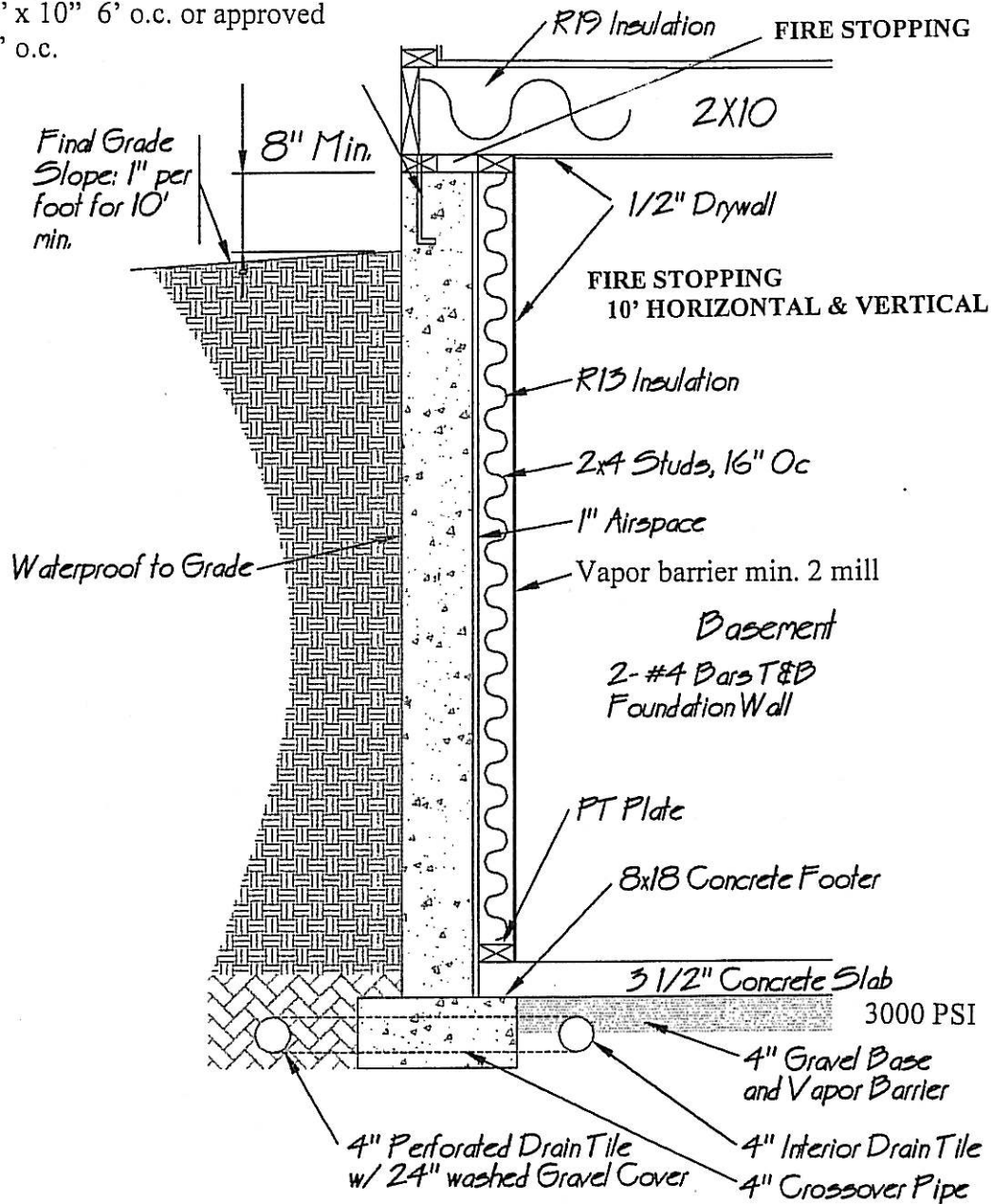

Final Grade
 Slope: 1" per
 foot for 10'
 min.

8" Min.

Waterproof to Grade

FIRE STOPPING
 10' HORIZONTAL & VERTICAL

R13 Insulation

2x4 Studs, 16" Oc

1" Airspace

Vapor barrier min. 2 mill

Basement

2- #4 Bars T&B
 Foundation Wall

PT Plate

8x18 Concrete Footer

3 1/2" Concrete Slab
 3000 PSI

4" Gravel Base
 and Vapor Barrier

4" Perforated Drain Tile
 w/ 24" washed Gravel Cover

4" Interior Drain Tile
 4" Crossover Pipe

10/97

This drawing is a sample of general building code requirements for one aspect of a construction project and is for illustration purposes only. Following this example does not mean that your drawing will comply with the Butler County Building Code or be approved, as special circumstances may exist which could require deviation from this illustration to satisfy the Code. Consult a qualified professional for any questions you have about how special circumstances may affect your building project.